

ARMODILO™

Tilt Tablet Mount

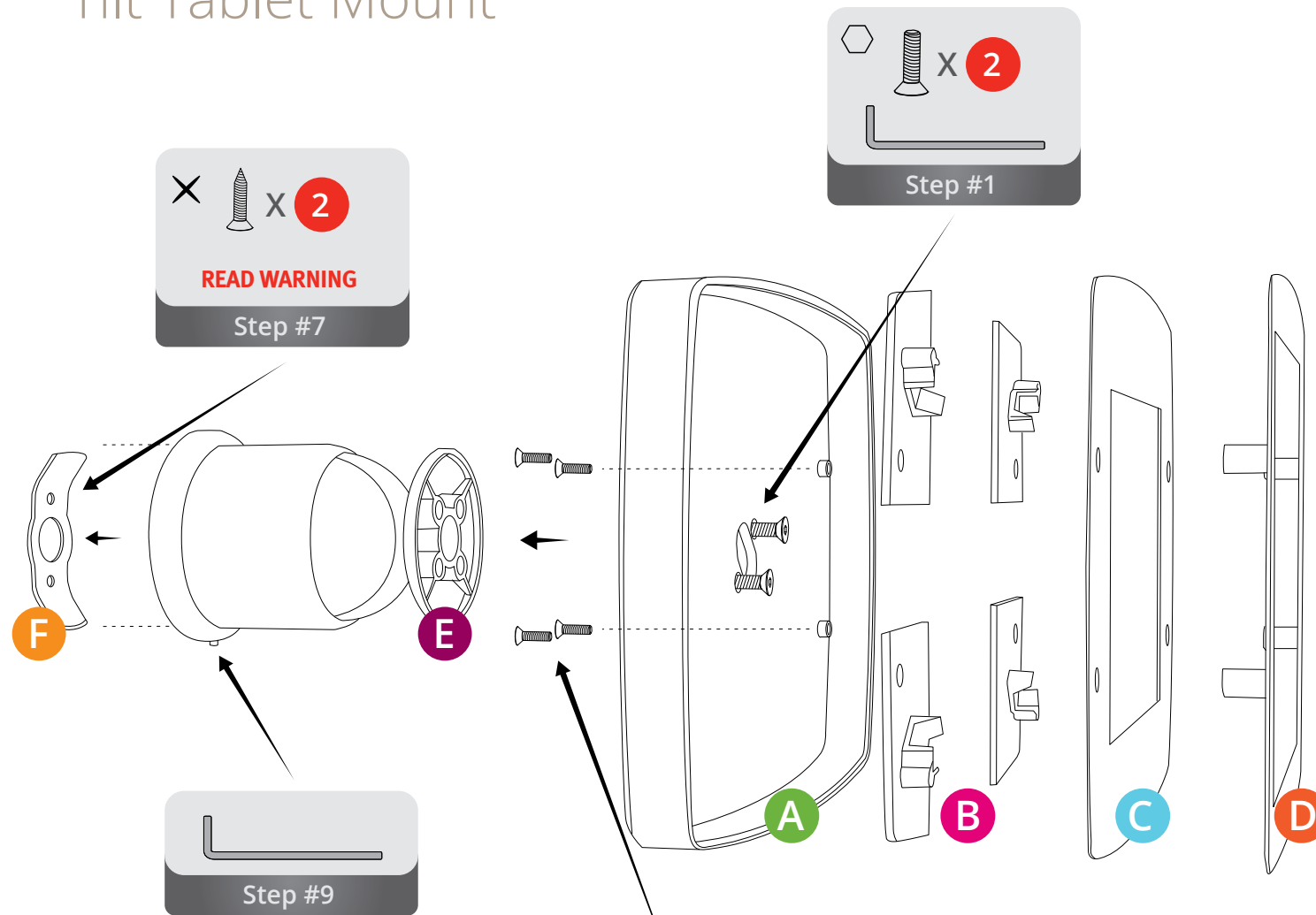

X X 2
READ WARNING
Step #7

X 2
Step #1

X 4
Step #6

Step #9

Tilt Assembly

- 01 Connect **A** to **E** in either landscape or portrait orientation using two screws
- 02 Insert 4 x **B** into **A**
- 03 Insert your tablet
- 04 Cover Tablet with **C**
Remove protective plastic on first use
- 05 Cover **C** with **D**
- 06 Secure **D** by putting 4 security screws in through the back of **A**
- 07 Fasten **F** to the wall using appropriate bolts or screws*
- 08 Hang complete assembly **A** + **E** onto **F**
- 09 Tighten set screw at the base of **E** to secure Wall Mount to the bracket

WARNING: * Ensure that the wall mount bracket **F** is mounted to a sturdy anchor point such as a stud. Mounting the bracket to drywall is **not recommended** as the force required to move the tilt mechanism up or down can pull mounting hardware out of weaker surfaces such as drywall.

Caution: Ensure enclosure is facing upwards when removing security screws to ensure tablet does not fall out.

For full Assembly Instructions and Warranty Information visit: armodilo.com